

RoHS

REV.	EC#	DESCRIPTION	DATE	DRAWING	CHECKED	APPROVED
A0		NEW RELEASE	2018.04.02	Michael	Mark	Cornelia

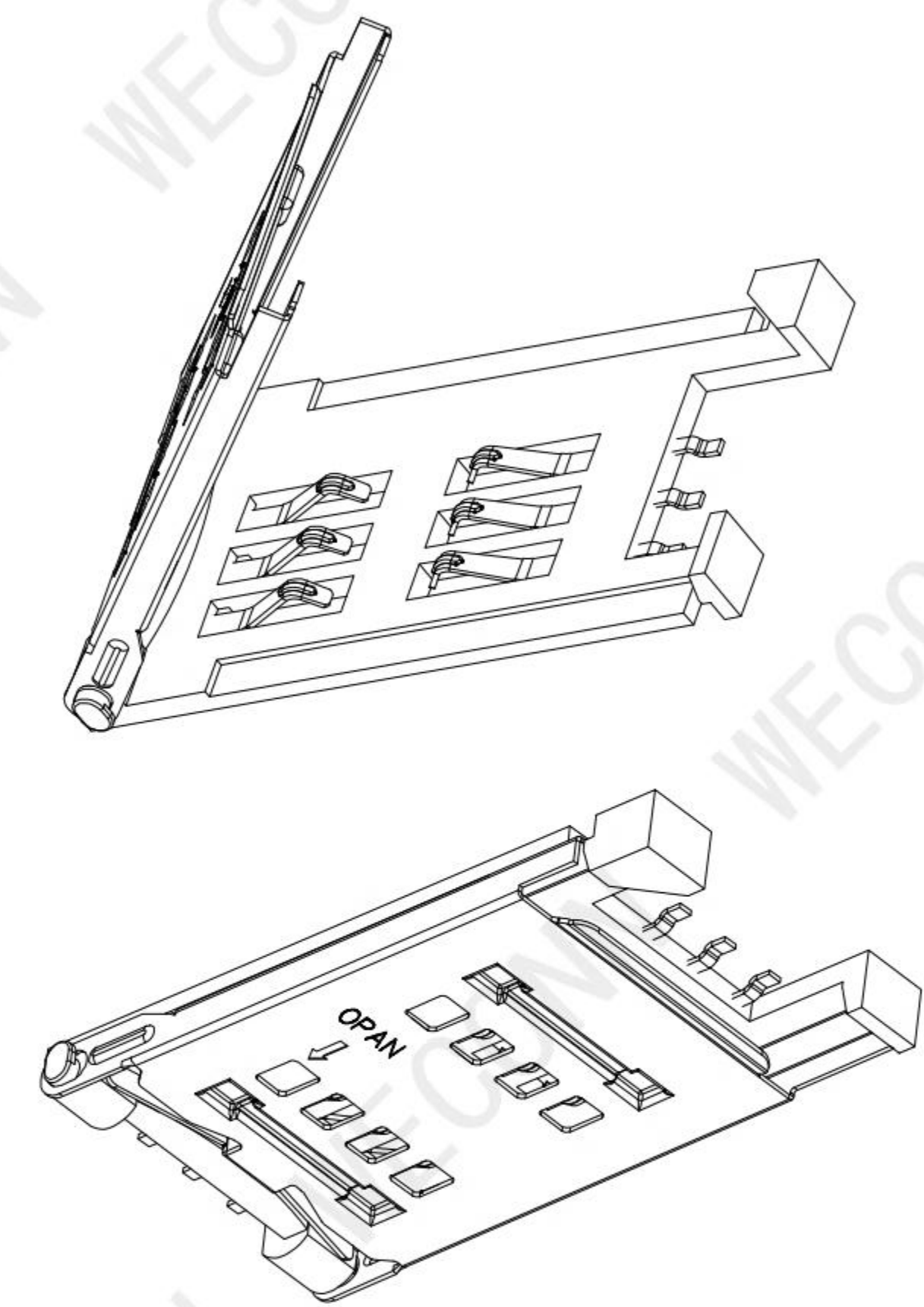

PCB LAYOUT RECOMMENDED

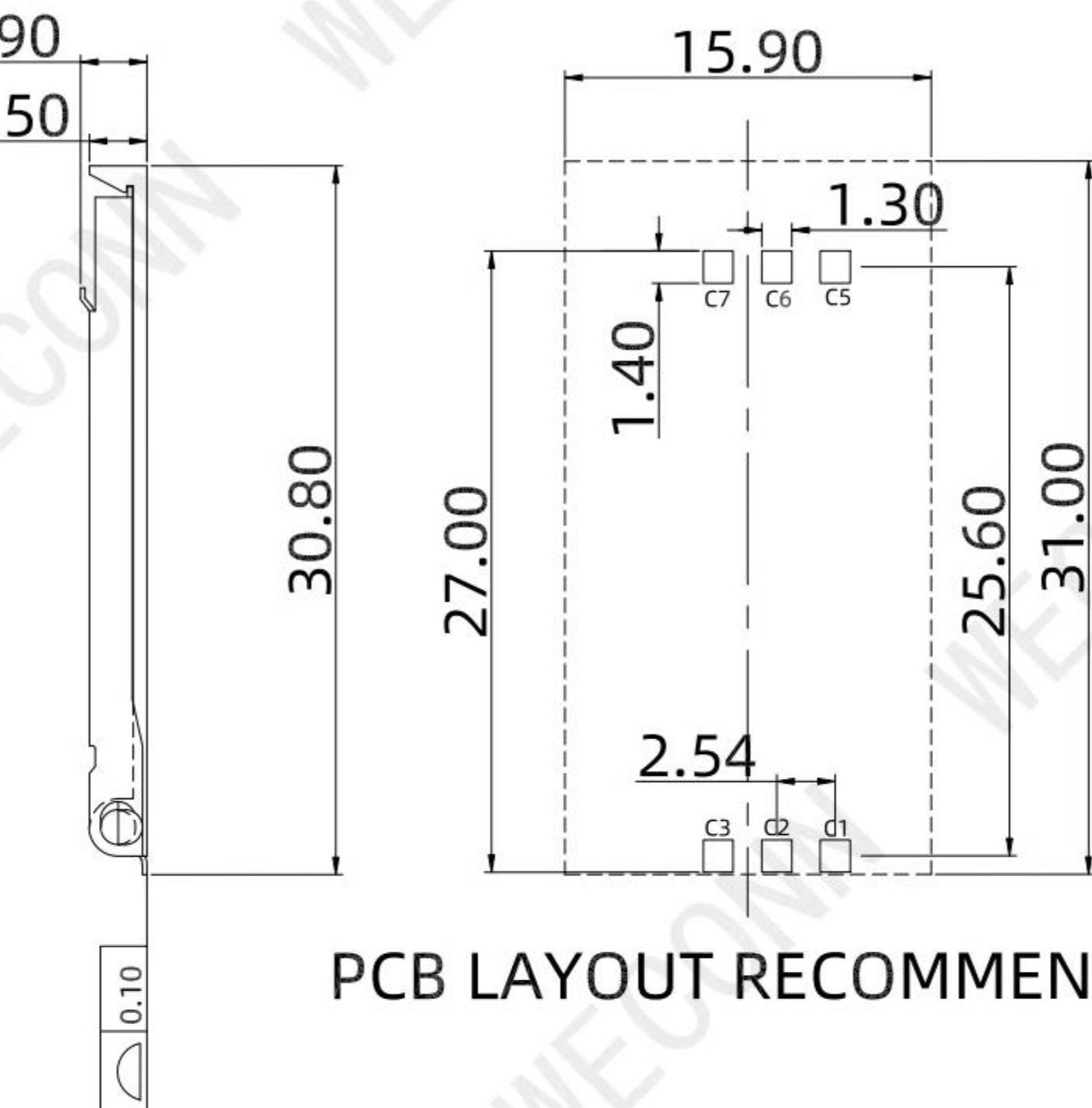
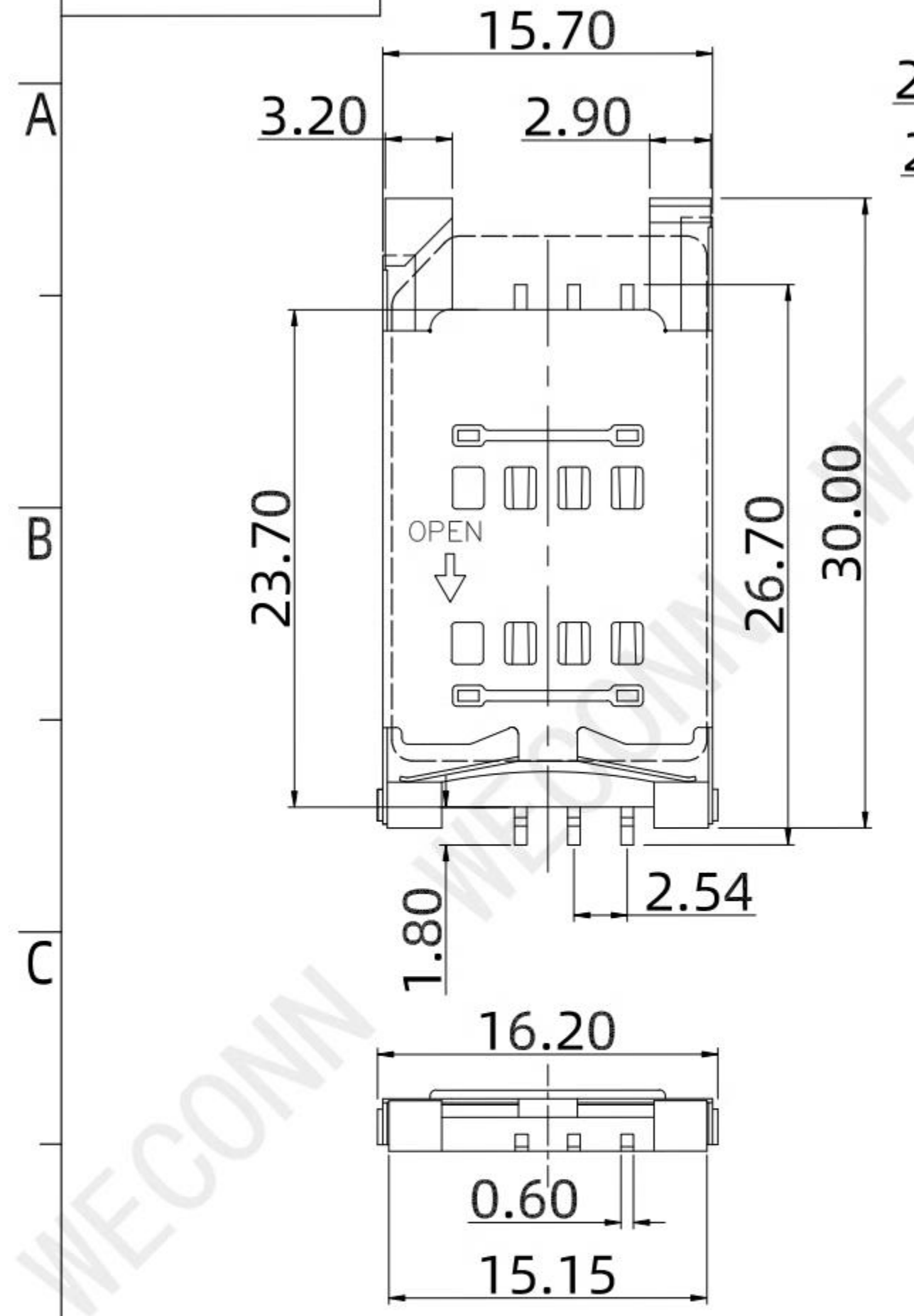
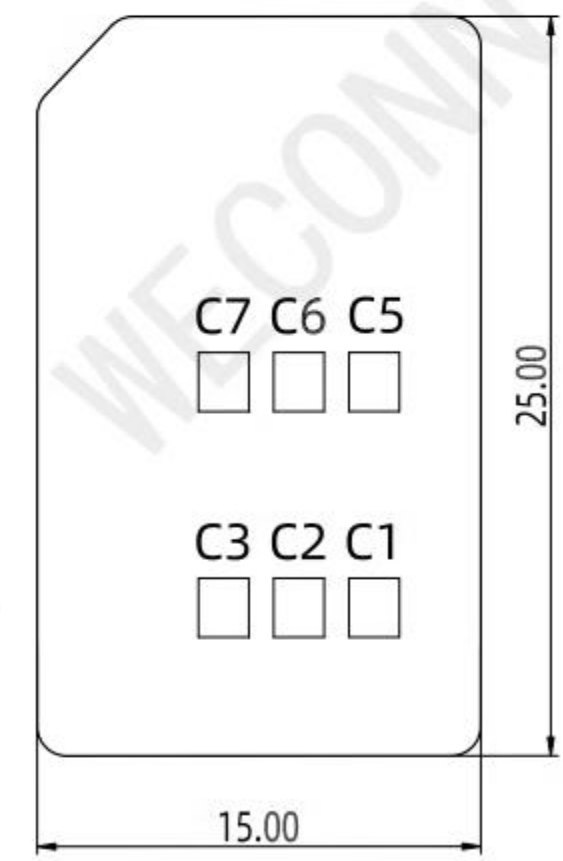

REFERENCE SIM CARD PLUG

SIM Card Connector, With Cover, Type 1, 8 Pin
 Physical:
 Housing: LCP UL 94V-0
 Contact: Selective Gold Flash
 Specifications:
 Voltage Current rating: 1A. 50V AC
 Insulation Resistance: 1000Mohm
 Min Contact Withstanding Voltage: AC 500V For 1 Minute
 Temperature Rating: -40° To +85°

SIM pin Assignment	
PIN#	Name
C1	VCC
C2	RST
C3	CLK
C5	GND
C6	VPP
C7	I/O

PLEASE CONTACT WELINK SALES REPRESENTATIVE TO VERIFY PRODUCT DETAILS & AVAILABILITY

MILLIMETERS	INCH	UNITS	WECONN® 深圳市微连电子有限公司 ShenZhen Welink Electronics Co.,Ltd			
X° ± 2°	X° ± 2°	MM	PART NUMBER: WL-SIM180-099		TITLE: SIM卡座 翻盖式 6P 2.9H 铁盖	
.X ± 0.30	.XX ± 0.012	MAT'L SEE NOTES	DWG NO.: WL-SIM180-099		APPD: Cornelia	
.XX ± 0.20	.XXX ± 0.008	FINISH SEE NOTES	SCALE		CHKD: Mark	
.XXX ± 0.10	.XXXX ± 0.004	QTY SEE NOTES	1:1	SHEET 2/2	REV. A1	DR: Michael

THESE DRAWINGS AND SPECIFICATION ARE WELINK SHENZHEN WELINK ELECTRONICS CO.,LTD COPIED OR USED IN ANY MANNER WITHOUT WELINK SHENZHEN WELINK ELECTRONICS CO.,LTD

RoHS

REV.	EC#	DESCRIPTION	DATE	DRAWING	CHECKED	APPROVED
A0		NEW RELEASE	2018.04.02	Michael	Mark	Cornelia

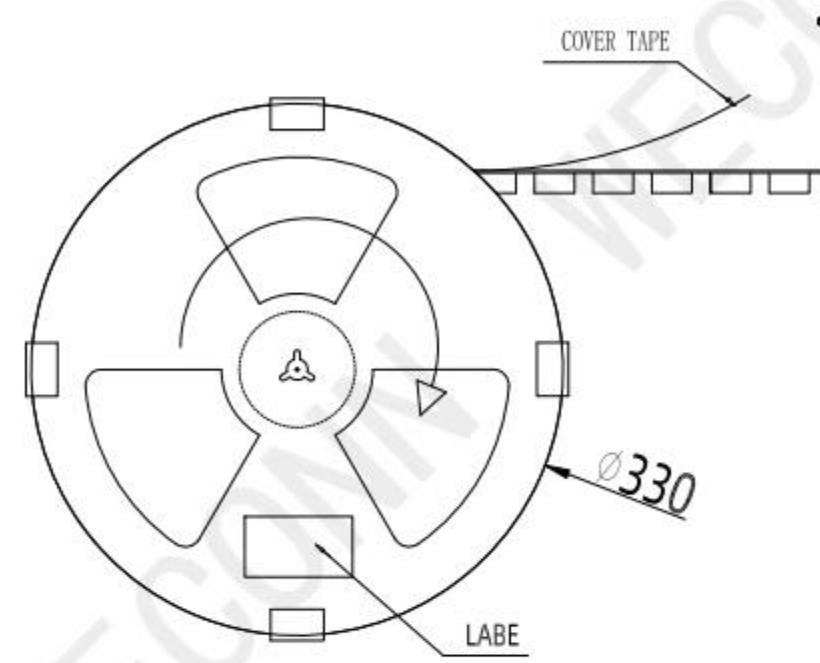
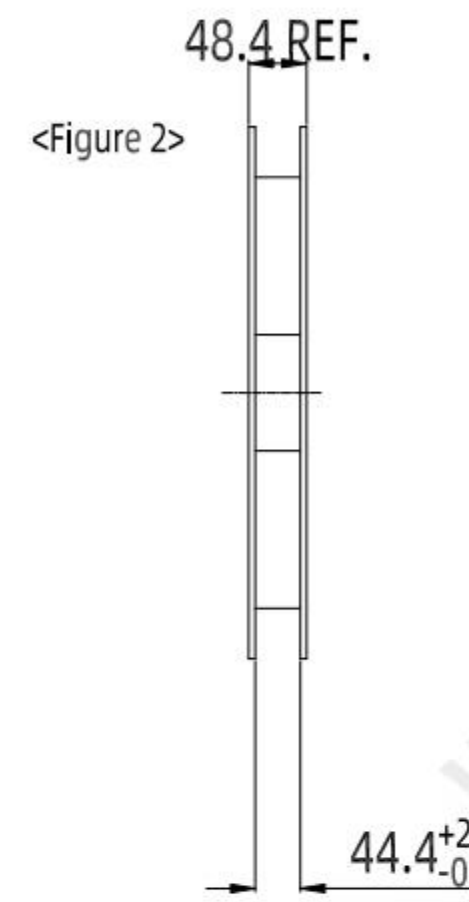
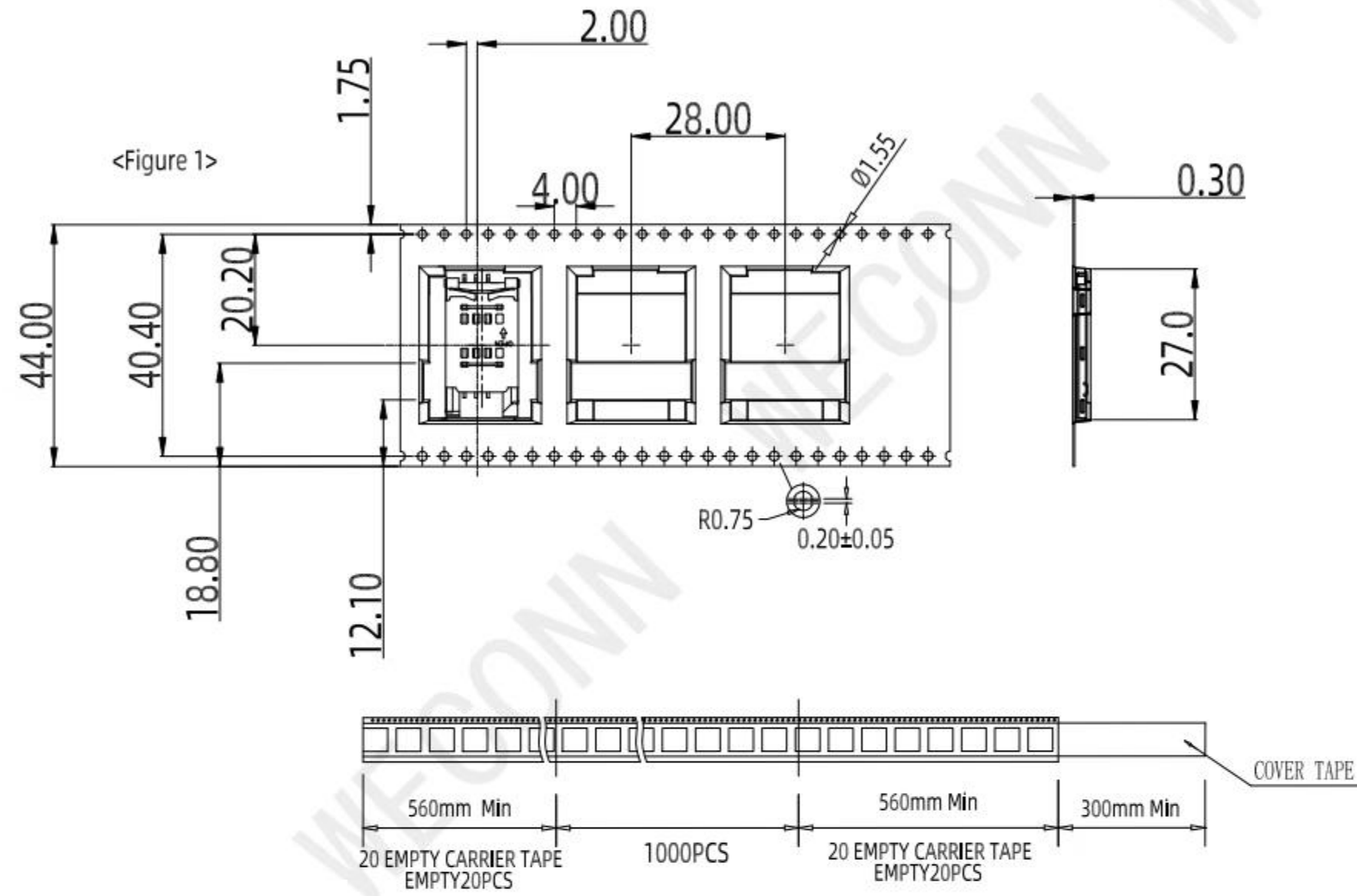

<TABLE 1> PACKAGING QUANTITY

QTY/REEL	REEL/CARTON	QTY/CARTON
1000	6	6000

COVER TAPE PEELING FORCE: 20gf~120gf

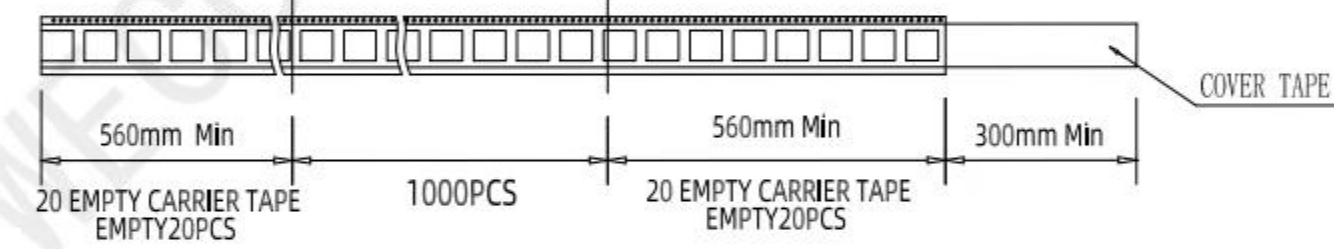
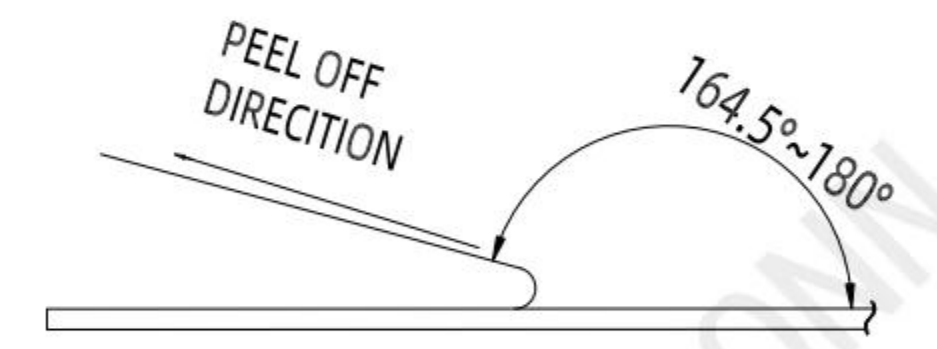

<Figure3>

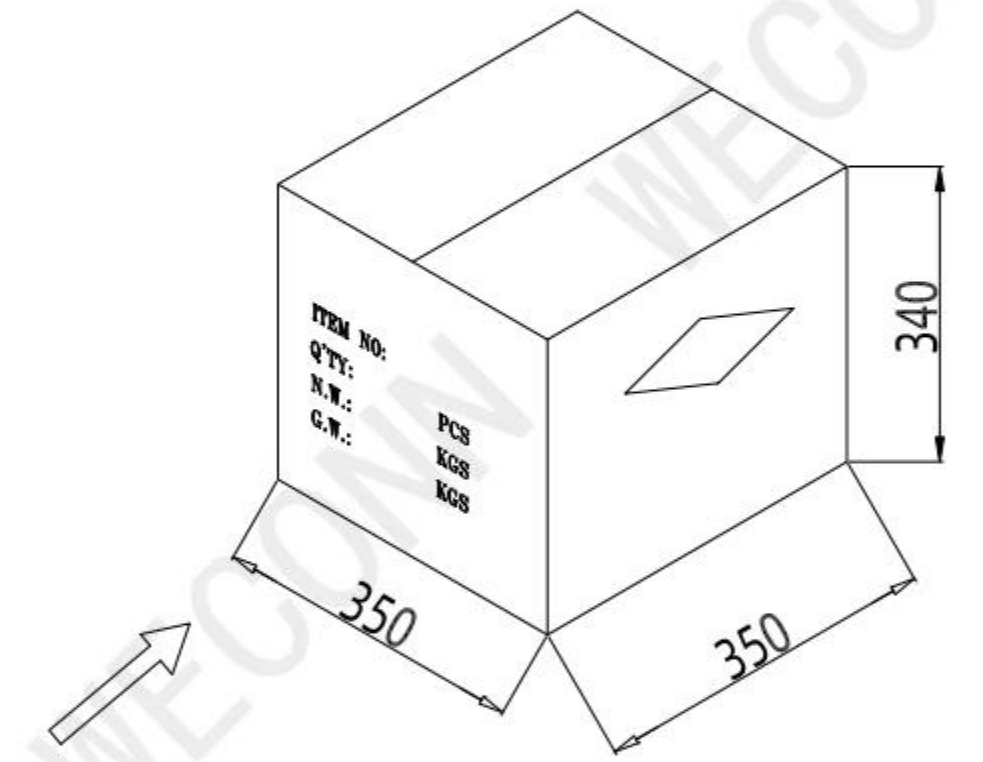
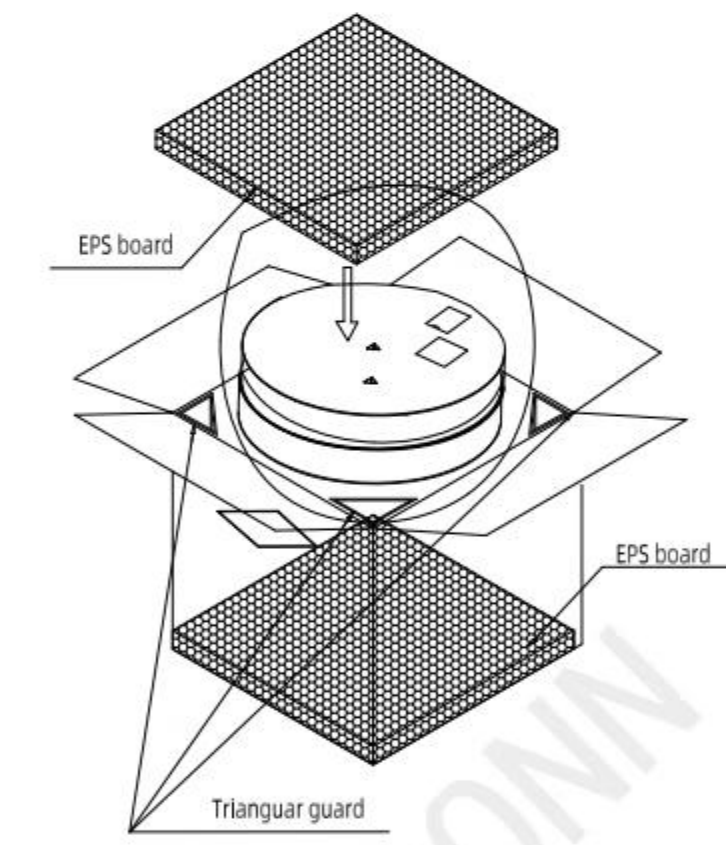
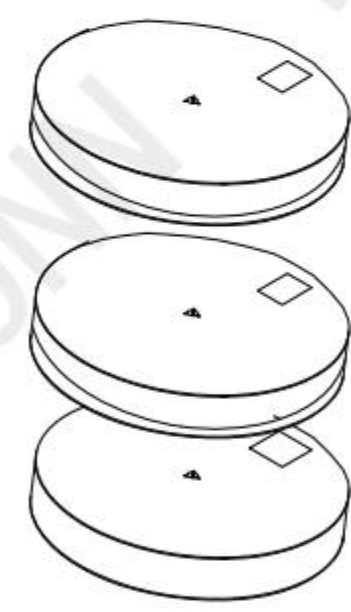

- NOTE:
- Place 1 PCS product per hole according to <Figure 1>.
 - After the packaging machine is wrapped, stick tape on each equal point of the REEL to prevent the REEL from scattered. label each REEL, as shown in <Figure 2>
 - The packaging quantity is shown as <TABLE 1>
 - Package, as shown in <Figure 3>
- Put the EPS board at the bottom of the box, and then put the REEL into the box. Put four triangular guards into the four corners, and put the EPS board on the top.
- Seal the box, write the material number, quantity, etc. on the sealed carton according to customer requirements

MILLIMETERS	INCH	UNITS	WECONN® 深圳市微连电子有限公司 ShenZhen Welink Electronics Co.,Ltd			
X.° ± 2°	X.° ± 2°	MM	PART NUMBER: WL-SIM180-099		TITLE: SIM卡座 翻盖式 6P 2.9H 铁盖	
.X ± 0.30	.XX ± 0.012	MAT'L SEE NOTES	DWG NO.: WL-SIM180-099		APPD:	Cornelia
.XX ± 0.20	.XXX ± 0.008	FINISH SEE NOTES	SCALE	SHEET	REV.	CHKD:
.XXX ± 0.10	.XXXX ± 0.004	QTY SEE NOTES	1:1	2/2	A1	DR:
THESE DRAWINGS AND SPECIFICATION ARE WELINK ShenZhen Welink Electronics Co.,Ltd COPIED OR USED IN ANY MANNER WITHOUT WELINK ShenZhen Welink Electronics Co.,Ltd			Michael			