

RoHS

REV.	EC#	DESCRIPTION	DATE	DRAWING	CHECKED	APPROVED
A0		NEW RELEASE	2018.12.12	Michael	Mark	Cornelia

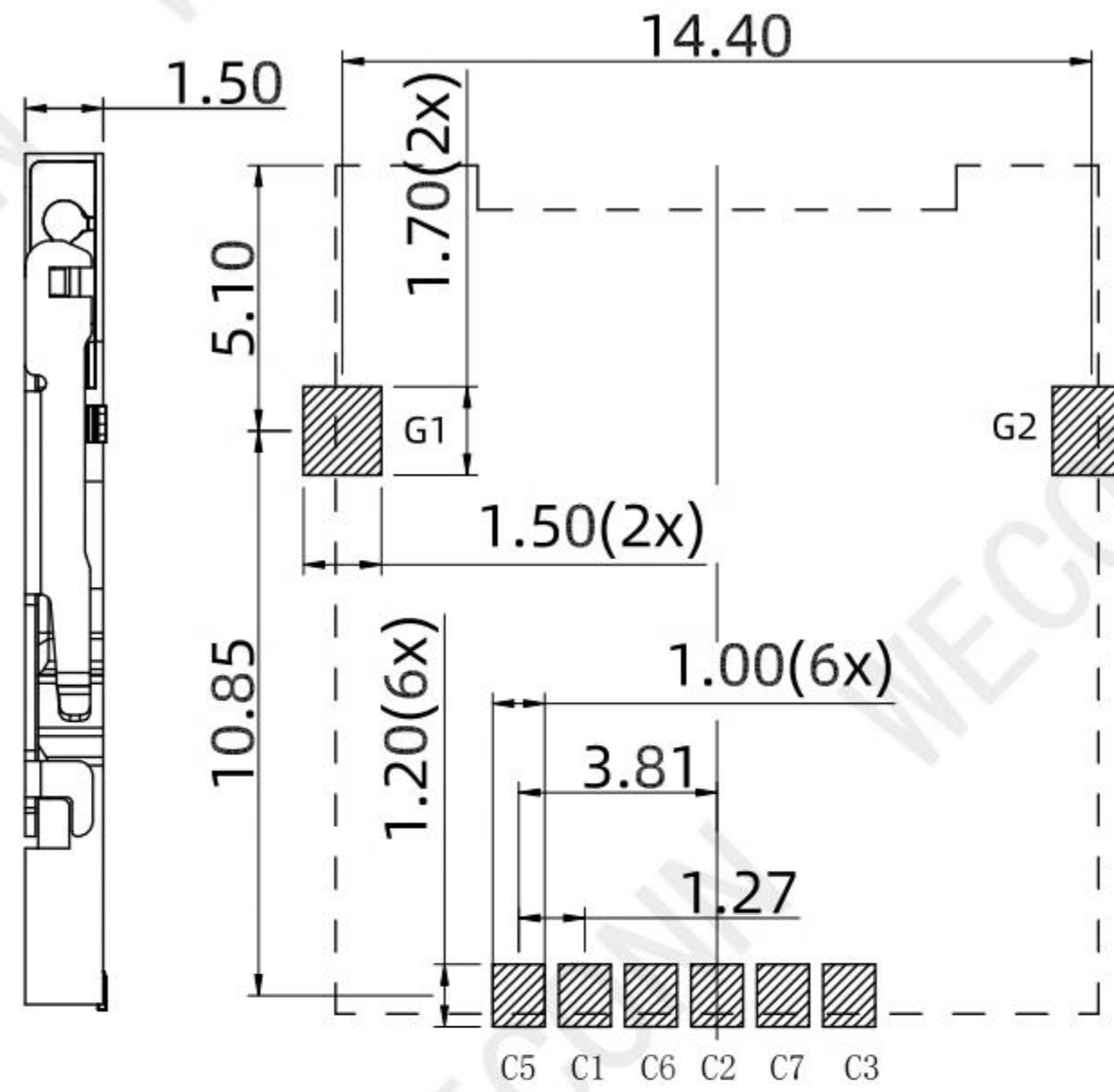

RECOMMENDED PCB LAYOUT(TOP VIEW)  
GENERAL TOLERANCES:±0.05  
G1-GN pin is defined as GND

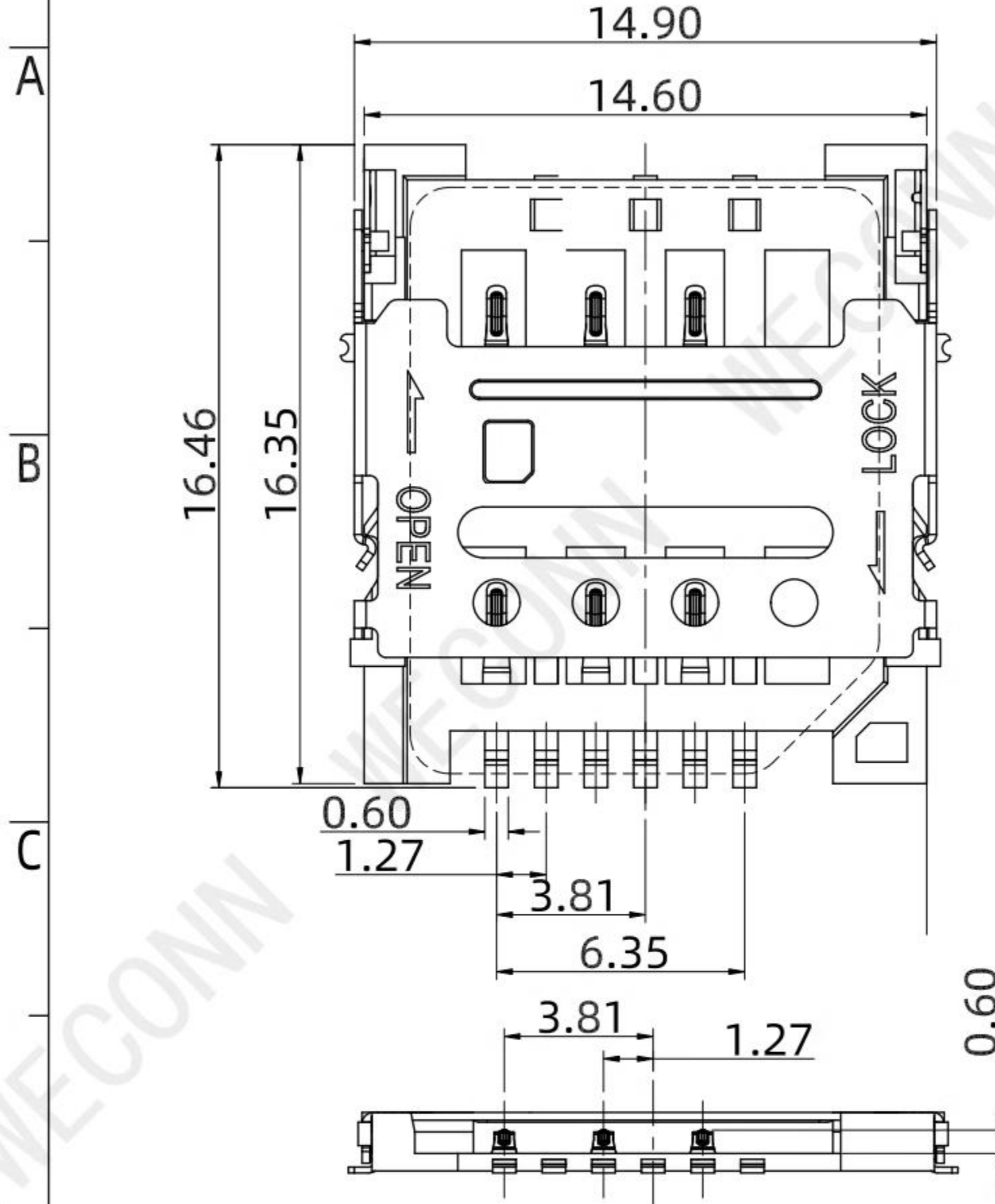
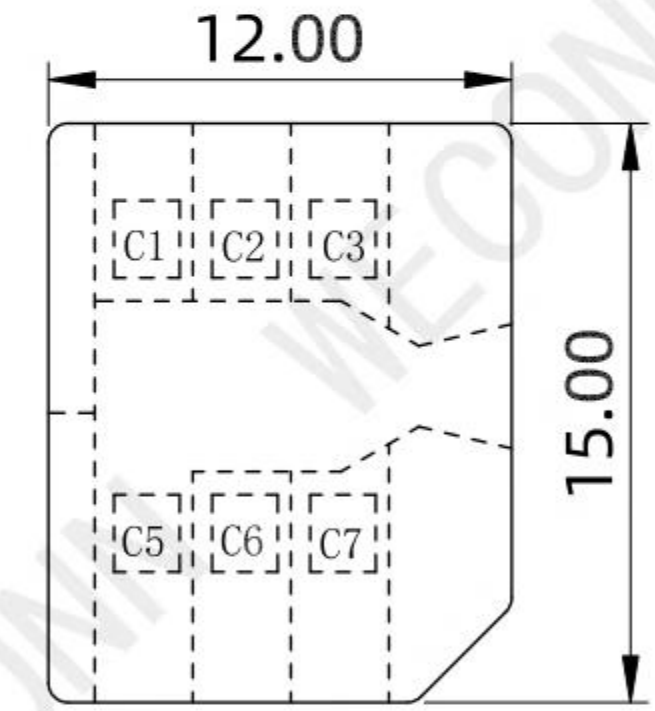
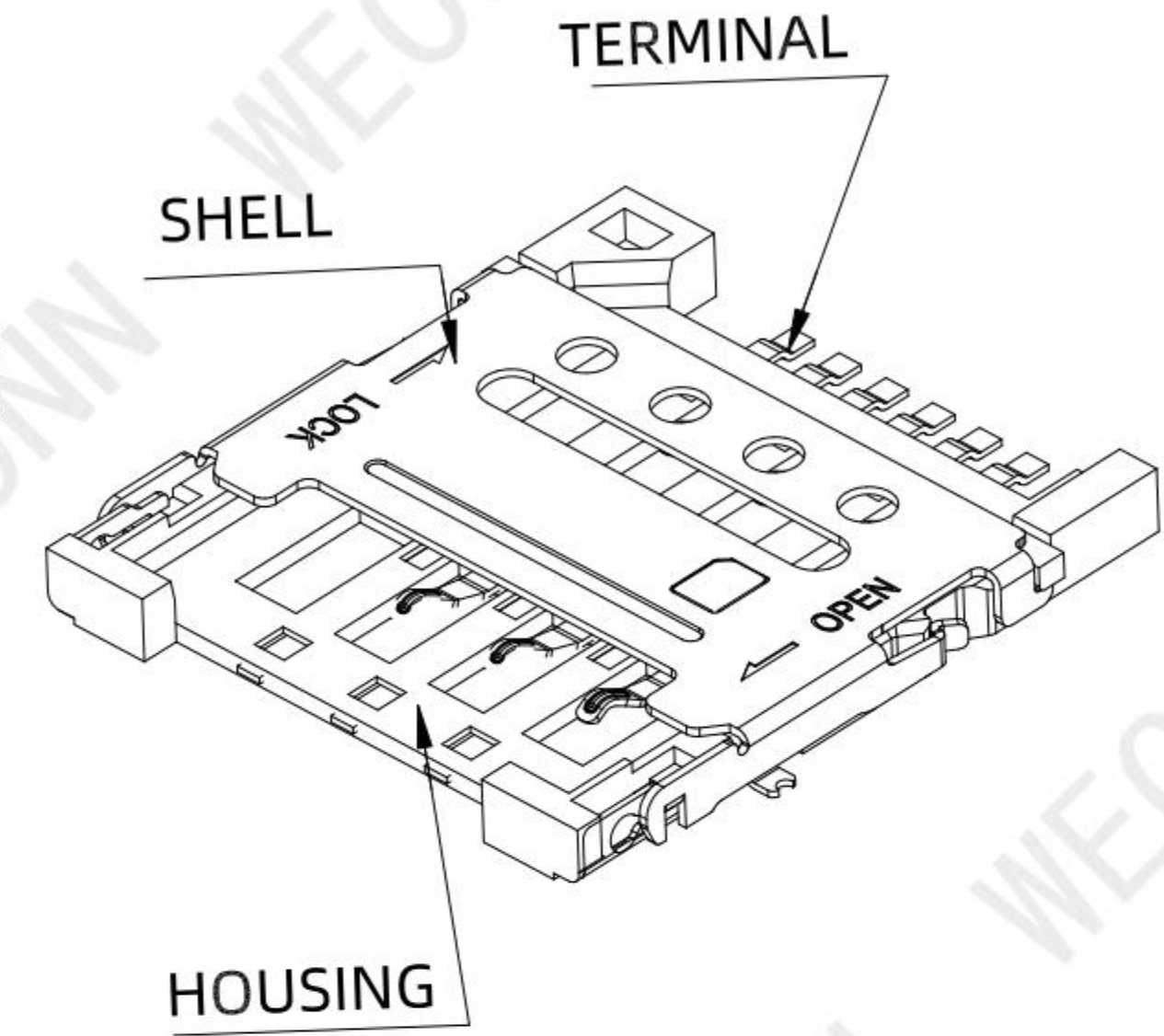

SIM CARD	
Pin No.	NAME
C1	VCC
C2	RST
C3	CLK
C5	GND
C6	VPP
C7	I/O

NOTES:

1.MATERIALS

- 1).HOUSING : HI-TEMP PLASTIC UL 94V-0.
- 2).TERMINAL: COPPER ALLOY.
- 3).SHELL : STANLESS STEEL.

2.FINISH

- 1).TERMINAL:GOLD PLATED ON CONTACT AREA, G/F GOLD PLATED ON SOLDER TAILS.
- 2).PEG: G/F GOLD PLATED ON SOLDER TAILS.

PLEASE CONTACT WELINK SALES REPRESENTATIVE TO VERIFY PRODUCT DETAILS & AVAILABILITY

MILLIMETERS	INCH	UNITS
X. <sup>o</sup> ± 2°	X. <sup>o</sup> ± 2°	MM
.X ± 0.30	.XX ± 0.012	MAT'L SEE NOTES
.XX ± 0.20	.XXX ± 0.008	FINISH SEE NOTES
.XXX ± 0.10	.XXXX ± 0.004	QTY SEE NOTES
THESE DRAWINGS AND SPECIFICATION ARE WELINK SHENZHEN WELINK ELECTRONICS CO.,LTD COPIED OR USED IN ANY MANNER WITHOUT WELINK SHENZHEN WELINK ELECTRONICS CO.,LTD		

<b>WECONN</b> 深圳市微连电子有限公司 ShenZhen Welink Electronics Co.,Ltd		
PART NUMBER: WL-SIM150-070		TITLE: MICRO SIM卡座 翻盖式 1*6P 1.5H
DWG NO.: WL-SIM150-070		APPD: Cornelia
SCALE 1:1	SHEET 1/2	CHKD: Mark
REV. A1	DR: Michael	

RoHS

REV.	EC#	DESCRIPTION	DATE	DRAWING	CHECKED	APPROVED
A0		NEW RELEASE	2018.12.12	Michael	Mark	Cornelia

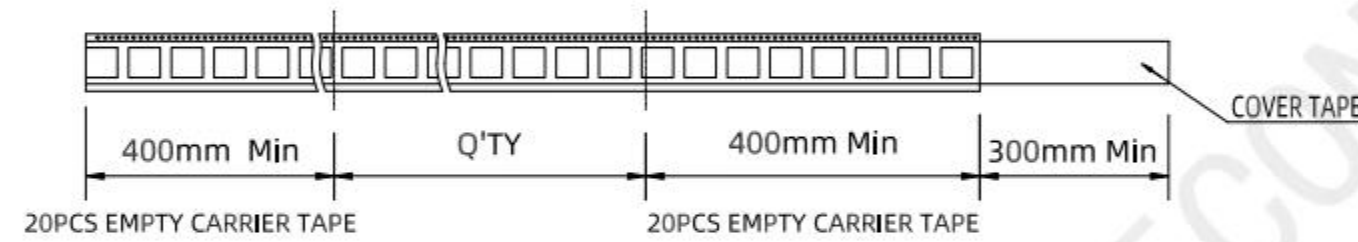
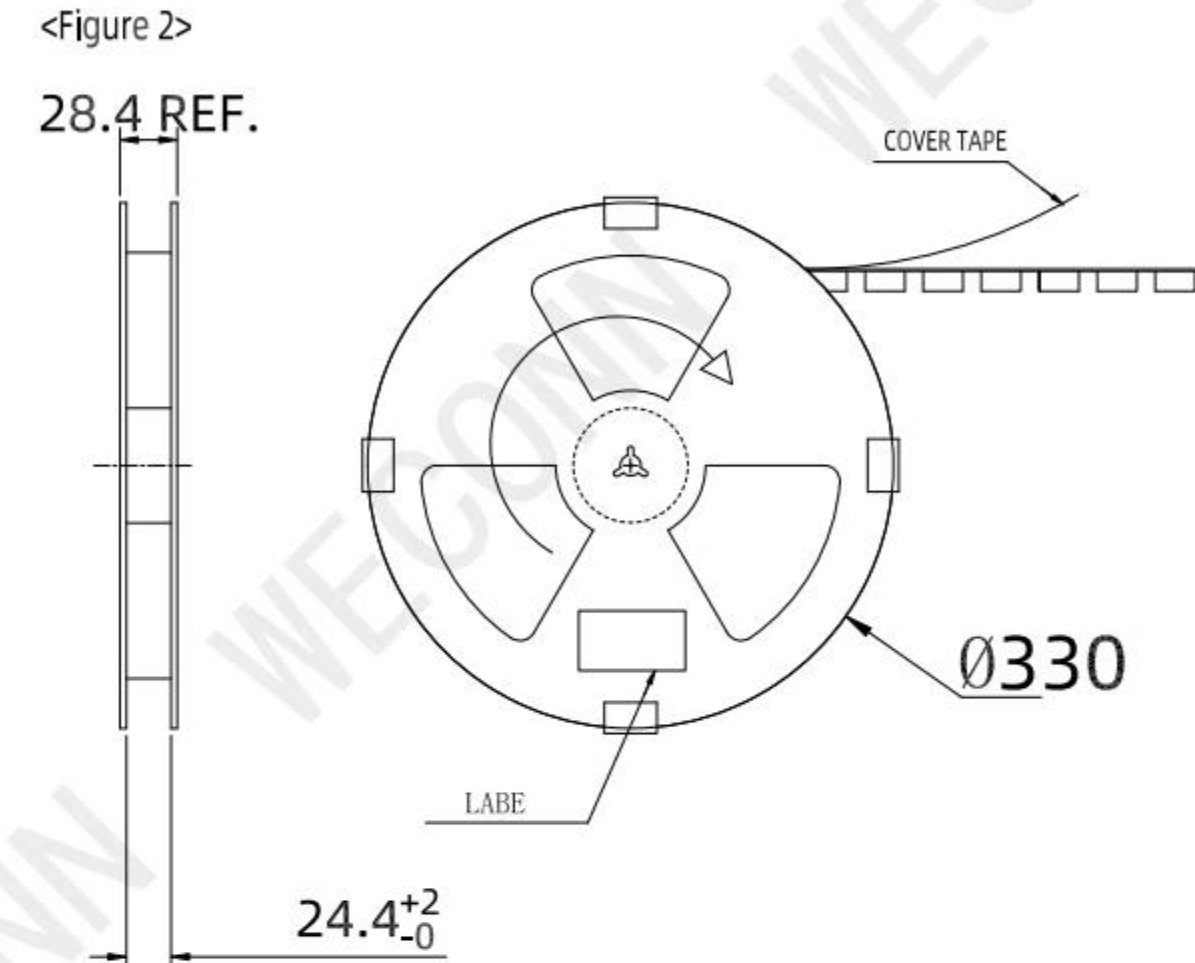
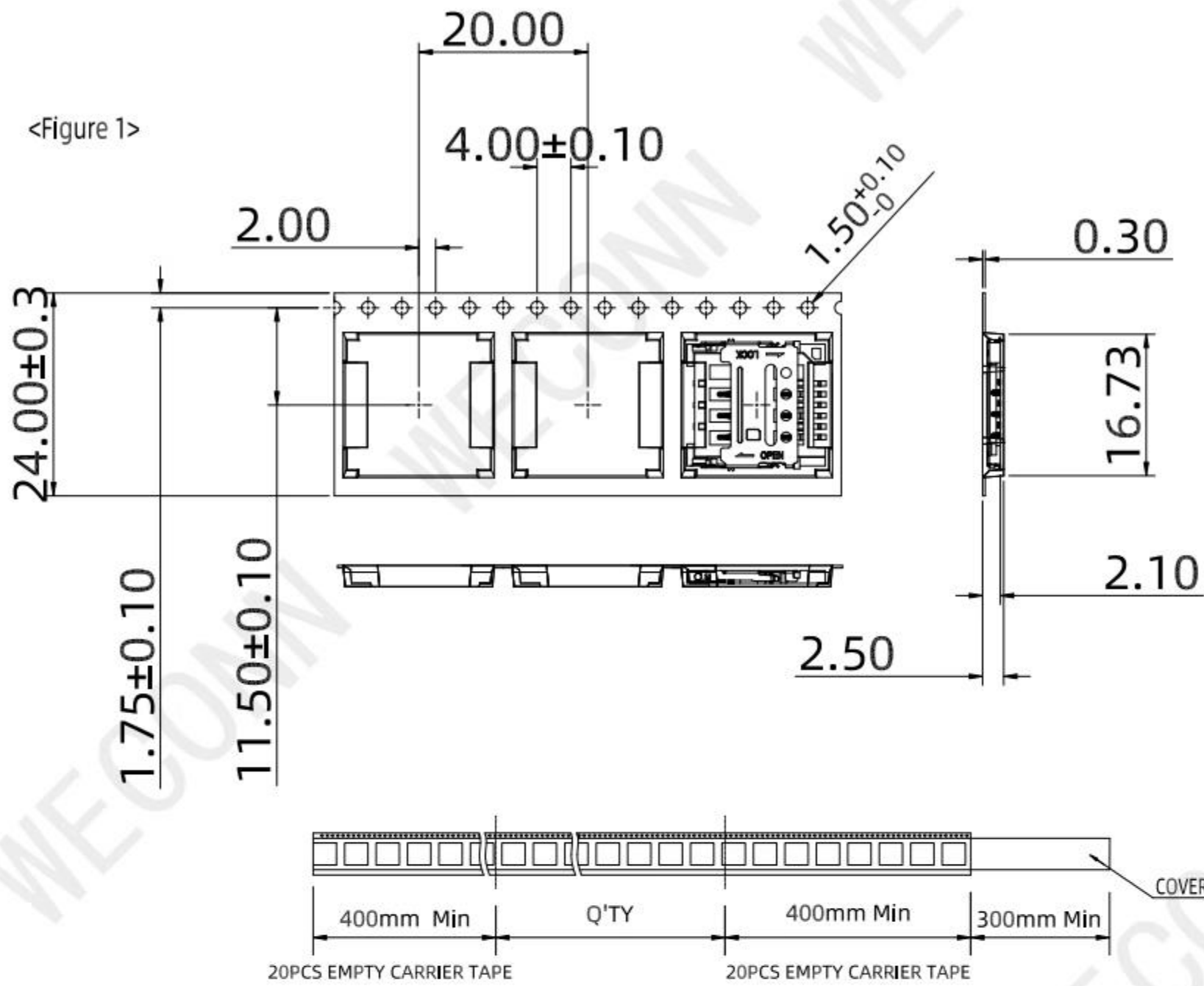

<TABLE 1> PACKAGING QUANTITY

QTY/REEL	REEL/CARTON	QTY/CARTON
1250	10	12500

NOTE:

- Place 1 PCS product per hole according to <Figure 1>.
  - After the packaging machine is wrapped, stick tape on each equal point of the REEL to prevent the REEL from scattered. label each REEL, as shown in <Figure 2>
  - The packaging quantity is shown as <TABLE 1>
  - Package, as shown in <Figure 3>
- Put the EPS board at the bottom of the box, and then put the REEL into the box. Put four triangular guards into the four corners, and put the EPS board on the top.
- Seal the box, write the material number, quantity, etc. on the sealed carton according to customer requirements

<Figure 3>

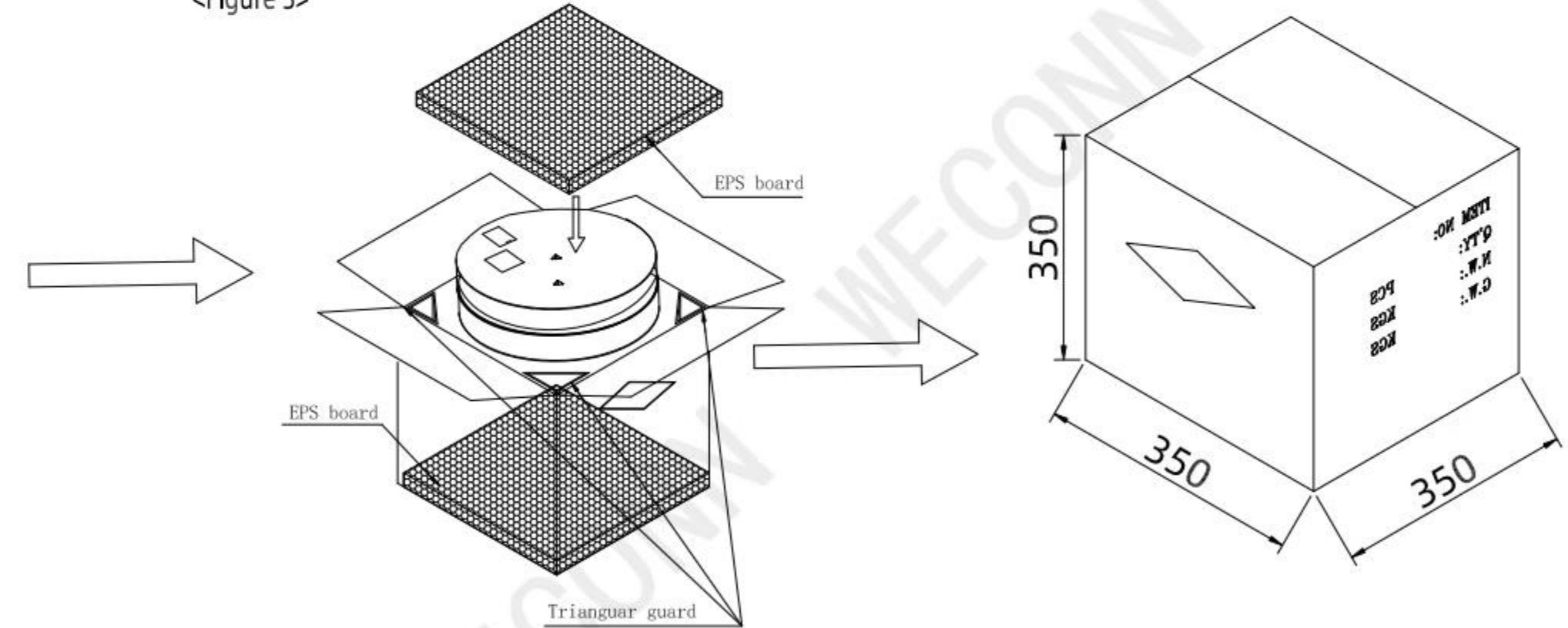

MILLIMETERS	INCH	UNITS	WECONN® 深圳市微连电子有限公司 ShenZhen Welink Electronics Co.,Ltd			
X° ± 2°	X° ± 2°	MM	PART NUMBER: WL-SIM150-070		TITLE: MICRO SIM卡座 翻盖式 1*6P 1.5H	
.X ± 0.30	.XX ± 0.012	MAT'L	DWG NO.: WL-SIM150-070		APPD:	Cornelia
.XX ± 0.20	.XXX ± 0.008	SEE NOTES	SCALE	SHEET	REV.	CHKD:
.XXX ± 0.10	.XXXX ± 0.004	FINISH	1:1	2/2	A1	DR:
QTY						
SEE NOTES						
THESE DRAWINGS AND PECIFICATION ARE Welink ShenZhen Welink Electronics Co.,Ltd COPIED OR USED IN ANY MANNER WITHOUT Welink ShenZhen Welink Electronics Co.,Ltd						